

The G2, G3, and G4 tension clamps from Tractel are lifting devices designed to grip and keep wires and cables taut. They are particularly useful for binding or tightening operations. This tool is used with a tensioning device, such as the Tirfor* or Bravo*, which is anchored to a shackle."



* Information about the traction devices in our range can be obtained upon request from Tractel or on www.tractel.com.

APPLICATIONS

- Cabling
- Line tension

TECHNICAL CHARACTERISTICS

- Light, compact, robust and easy to use.
- Coating: Epoxy paint for optimal protection against impacts and corrosion

Code	Description	Ø Cable compatibility (mm)	Max. Using Force ⁽¹⁾ (daN)	Dimensions (mm)			
				W	X	Y	Z
1018	G2 Tension clamp	6 - 8	400	80	88	123,3	40,5
1028	G3 Tension clamp	7 - 15	600	95	110	155,7	53,5
1038	G4 Tension clamp	14 -18	800	95	115	162,7	57,6

⁽¹⁾in traction only.

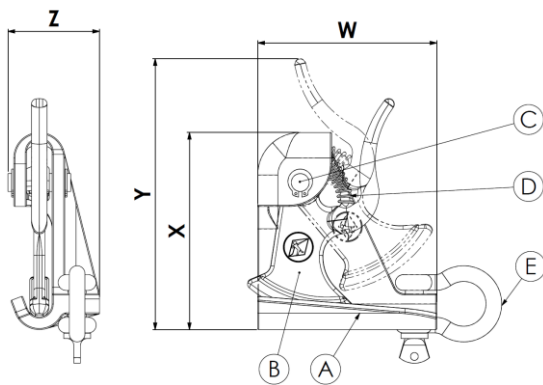

- A. Aluminium body
- B. Forged and galvanized steel cam
- C. Treated and galvanized steel camshaft."
- D. Spring
- E. Bow shackle

PRODUCT CODE AND LOGISTIC INFORMATION

Code	Description	Code EAN	Weight Net (kg)
1018	G2 Tension clamp	3600230010182	0.29
1028	G3 Tension clamp	3600230010281	0.57
1038	G4 Tension clamp	3600230010380	0.67

SETTING UP

